

FDS-32 Solar DC Fuse



Application

A range of 10x38mm fuse links specifically designed for protecting photovoltaic strings. These fuse links are capable of interrupting low overcurrents associated with faulted photovoltaic string arrays (reverse current, multi-array fault).

Structural Characteristics

- According to IEC60269-1
- Rated current: 1-32A
- Rated voltage: DC 1000V
- Rated breaking capacity: DC 33kA
- Operating class gPV for Solar protection

Specification

| | |
|------------------------------------|---|
| Pole | 1P |
| Rated Voltage Ue (V DC) | 1000 |
| Rated Current In (A) | 1, 2, 3, 4, 5, 6, 8, 10, 12, 15, 20, 25, 32 |
| Biggest Block Ability(KA) | 33 |
| The Most High Power Consumption(W) | 3.5 |

Connection and Installation

| | |
|------------------------------|--------------------------------|
| Connection(mm ²) | 2.5 -1 0 |
| Working Temperature(°C) | -30~+70 |
| Resistance And Damp Hot | Class 2 |
| Altitude(m) | ≤ 2000 |
| Relative Humidity | ≤ 95% |
| Protection Class/Degree | IP20 |
| Pollution | 3 |
| Installation Environment | No obvious shock and vibration |
| Installation Class/Type | Class III/DIN rail |

Size(mm)

| Size/Dimension(mm) | | |
|--------------------|---|-------|
| (WxHxL) | W | 18 |
| | H | 60 |
| | L | 78 |
| Fuse Size | | 10x38 |
| Weight (kg) | | 0.07 |

PV fuse Description

- Photovoltaic system fuse accord with UL248-1 standard.
- Photovoltaic battery dc fuse designed to used for photovoltaic (PV) system.
- Main effect is to protect the solar panels. Solar panels points in effective condition is broken.
- Fault light cells break points at the same time, does not affect other normal work of light from the stack.
- Technical Data Rated coltage: DC1000V Breaking capacity: 25KA Function level: PV.

SOLAR DC FUSE

Dimensions

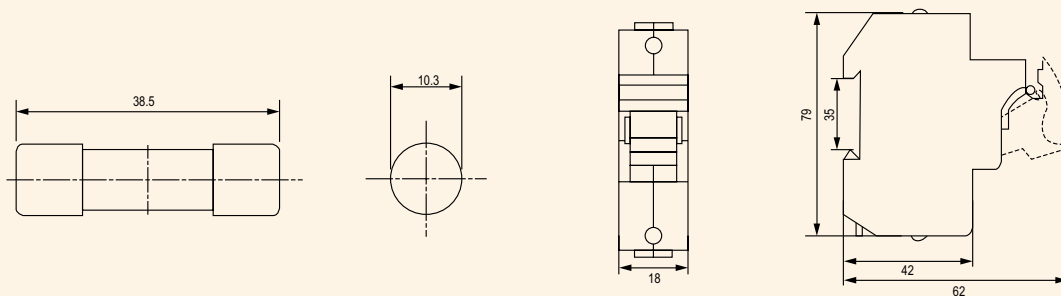

Installation

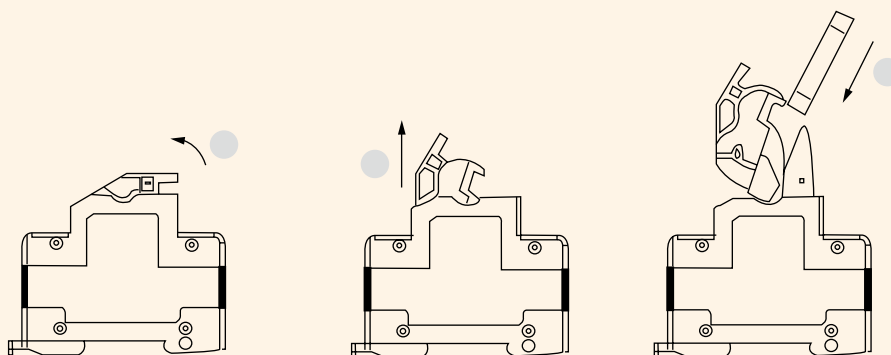

Characteristic Curve

